

Dupli-Color[®]

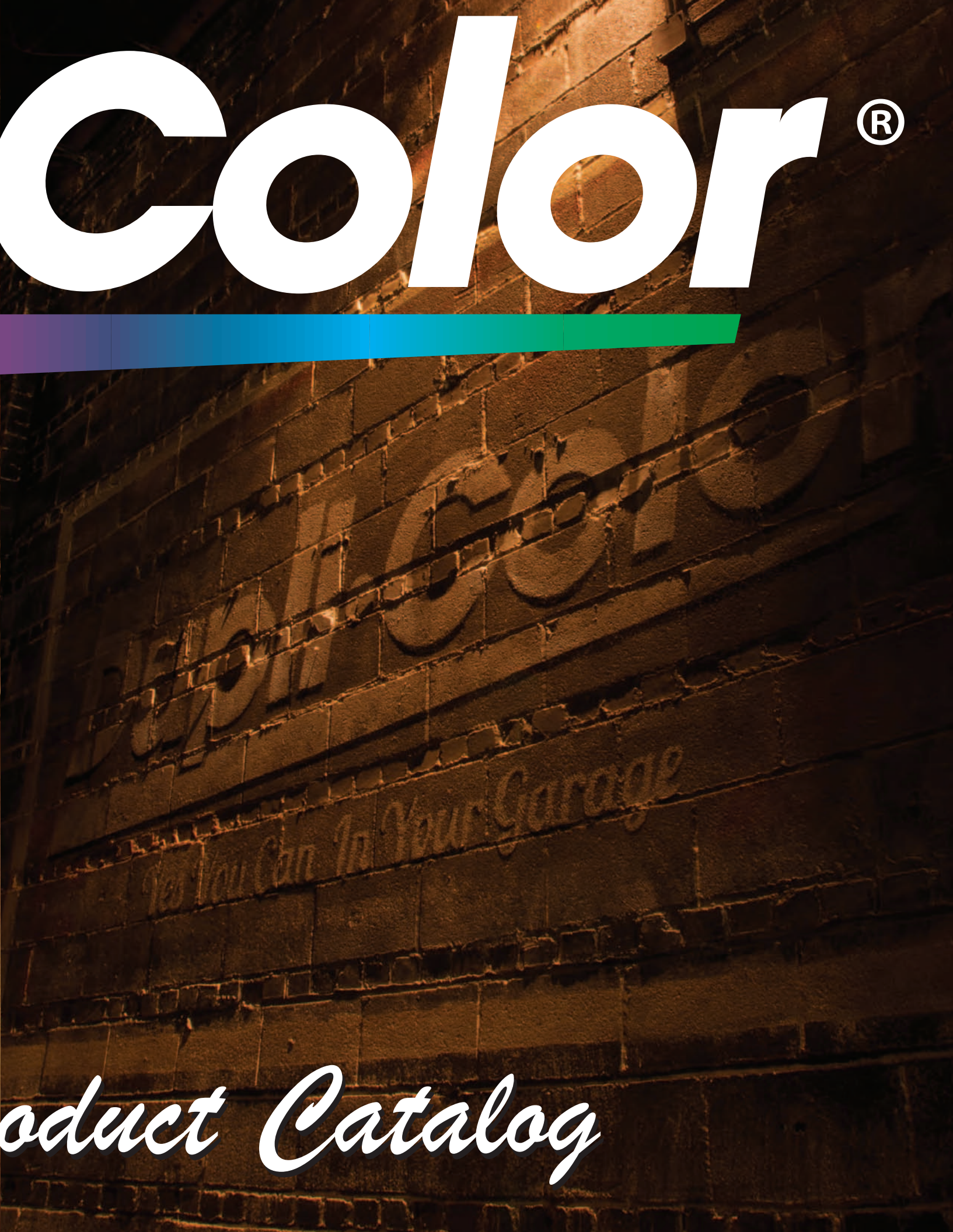

Automotive Product Catalog



Primers

AUTOMOTIVE PRODUCTS SINCE

1938



FILLER PRIMER

12 oz. cans - Case Pack: 6

Dupli-Color® Filler Primer features a high build automotive formulation capable of filling deep scratches and minor surface imperfections. A fast-drying, sandable finish allows for easy feather edging while providing a smooth and rust resistant surface that promotes top coat uniformity.

- Features EZ Touch® Fan Spray Nozzle
- Fills deep scratches and minor imperfections
- Improves top coat adhesion
- High build formula
- Easy sanding properties
- Dry to touch in 30 Minutes / Handle in 1 Hour
- Use on metal, wood, and fiberglass surfaces

Gray Filler Primer FP101 0-26916-32101-5	Red Oxide Filler Primer FP102 0-26916-32102-2
--	---

SELF ETCHING PRIMER

12 oz. cans - Case Pack: 6

Dupli-Color® Self-Etching Primer etches and primes bare metal in one step, making it ideal to use as the first step in all automotive priming projects and for use on spot repairs. A high-quality formulation allows for maximum adhesion under all types of automotive finishes on plastics, fiberglass, bare steel, aluminum and stainless steel surfaces.

- Features EZ Touch® Fan Spray Nozzle
- Superior etching ability on bare surfaces
- Perfect for spot repairs
- Maximum adhesion and corrosion resistance
- Dry to touch in 30 Minutes / Handle in 1 Hour
- Ideal for use on bare metal, aluminum, and fiberglass

Self-Etching Primer DAP1690 0-26916-94690-4

SANDABLE PRIMER

12 oz. cans - Case Pack: 6

Dupli-Color® Sandable Primer is an all-purpose, fast-drying primer that can be sanded to a smooth finish to help achieve topcoat uniformity. Great for smooth fill-in of surface cracks and imperfections and is effective on both painted and unpainted surfaces.

- Features EZ Touch® Fan Spray Nozzle
- Helps achieve top coat uniformity
- For use on pre-painted and unpainted surfaces
- Sands easily
- Dry to touch in 30 Minutes / Handle in 1 Hour
- Use on metal, wood, and fiberglass surfaces

Rust Resistant Primer DAP1687 0-26916-94687-4	Gray Hot Rod Primer DAP1692 0-26916-94692-8	Black Hot Rod Primer DAP1698 0-26916-94698-0
White Primer DAP1689 0-26916-94689-8	Red Oxide Primer DAP1694 0-26916-94694-2	

PRIMER SEALER

12 oz. cans - Case Pack: 6

Dupli-Color® Primer Sealer creates a smooth uniform surface for final coating by completely sealing the primed surface. Provides maximum corrosion resistance and improves bonding of base colors on all metal, wood, and fiberglass surfaces.

- Features EZ Touch® Fan Spray Nozzle
- Provides maximum corrosion resistance
- Provides a smooth uniform surface for top coat
- Dry to touch in 30 Minutes / Handle in 1 Hour
- Use on metal, wood, and fiberglass

Primer Sealer DAP1699 0-26916-94699-7



ADHESION PROMOTER

11 oz. cans - Case Pack: 6

Dupli-Color® Adhesion Promoter improves adhesion of enamel and lacquer top coats to all surfaces, including plastic and chrome. Adhesion Promoter is an all-purpose clear primer ideal for both interior and exterior applications.

- Features EZ Touch® Fan Spray Nozzle
- Improves top coat adhesion to plastic and chrome
- Quick drying clear primer
- Dry to touch in 20 Minutes / Handle in 1 Hour
- Use on interior and exterior applications
- Ideal for use on all metal and plastic surfaces

CP199 - Adhesion Promoter Clear Primer

Clear
CP 199
0-26916-34199-0

GREASE AND WAX REMOVER

Prep-Wipe - Single Towelette - Case Pack: 12,
Prep-Spray - 11 oz. - Case Pack: 6
Quart - 32 oz. - Case Pack: 6,

Surface preparation is a critical step in any quality painting project. Dupli-Color® simplifies your painting preparation needs by offering a complete line of Grease & Wax removers, including: Prep-Wipe, Prep-Spray, and Grease & Wax Remover in bulk gallon and quart containers. Each product removes dirt, road tar, grease, wax and oil from any surface without leaving a film residue.

- The very first step in any paint project
- Removes grease and wax prior to painting
- Promotes maximum paint adhesion
- Each Prep-Wipe towelette measures 8.5 in. x 11 in.
- Dries quickly with no residue

PW100 - Prep Wipe Towelette 0-26916-2000-6
PS100 - Prep Spray 0-26916-01756-4
CM541 - Quart 0-26916-60541-2

PAINT STRIPPER

11 oz. - Case Pack: 6

Dupli-Color® Paint Stripper quickly removes paint, varnish, shellac and lacquer in minutes. Effective on metal, wood, glass, and other hard surfaces, Dupli-Color® Paint Stripper penetrates into cracks and porous surfaces quickly and effectively.

- Quickly removes paint, varnish, and lacquer
- Wipes enamels away
- Can be used on most painted surfaces
- Penetrates into cracks

ST100 - Paint Stripper

Clear
ST100
0-26916-35100-5

RUST FIX®

10.25 oz. cans - Case Pack: 6

Dupli-Color® Rust Fix® destroys rust on contact by bonding and transforming it into a sandable and paintable surface. Sprays on clear and transforms into a black, metal protecting coating that prevents future rust from forming. Rust Fix saves you the time of sanding all the way down to bare metal and can be used with body filler and fiberglass.

- Destroys rust on contact
- Prevents future rust from forming
- Sands to smooth finish for top coating
- Dry to touch in 30 Minutes / Handle in 1 Hour

RF129 - Black

Black
RF129
0-26916-34129-7



FEATURING



SCRATCH-SEAL™ CLEAR SEALER PEN

Scratch•Seal™ is an easy-to-use, high-quality, fast-drying, clear paint specially formulated to permanently seal any scratch. It prevents the scratch from getting worse and becoming an expensive repair until you are ready to fully repair it with touch-up paint. It goes on clear and dries clear - virtually invisible.

SFSS100 - Scratch•Seal™ Clear Sealer Pen 0-26916-01414-6

0.4oz. pens - Case Pack 6

- Permanently seals scratches & chips to prevent further rust & flaking
- Stop the damage before it becomes an expensive repair

**Unprotected vehicle
scratch after only
30 days!**



NANO Molecule Normal Molecule

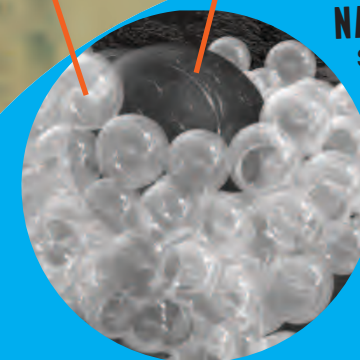

NANO-MOLECULAR-FORMULA™ ADVANCE SEAL

Scratch•Seal's Nano-Molecular-Formula™ provides an advanced seal on any scratch! The revolutionary new clear coating uses an interlocking molecular structure to create a denser, more durable seal with increased adhesion. The nano-sized molecules fill the voids created by larger molecules in order to prevent water penetration and seal out moisture that cause rust. When dry, it forms an extra-protective shell over the scratch to prevent damage from nature's elements of UV rays, salt and moisture.



SCRATCH FIX 2IN1™

Keep late-model, domestic and import cars, trucks, vans and SUV's looking new longer with Dupli-Color® Scratch Fix 2in1™ Premium Touch-Up Paint. The two applicators in one (roller ball tip and taper-tip brush) provide precision and control to repair nicks, chips and scratches with ease. Dupli-Color® Scratch Fix 2in1™ is offered in a complete line of OEM Exact-Match colors for the perfect finish.

.5 oz tubes — Case pack: 12

- Industry leading touch-up paint technology
- Complete line of OEM exact-match colors
- Roller ball tip ideal for precision and control
- Taper-tip brush ideal for large coverage
- Dry to touch in 20 Minutes / Handle in 40 minutes
- Clear coat needed to match original factory finish

See How

PREMIUM REPAIR KIT

For the ultimate in scratch and chip repair, Dupli-Color® Premium Touch-Up Repair Kit is the answer. The kit features improved tools and added elements that make it the most complete scratch and chip repair kit on the market. Designed for use with Scratch Fix 2in1™ touch-up paint, the Premium Touch-Up Paint Kit includes: Scratch Fix 2in1™ Filler Primer, Scratch Fix 2in1™ Clear Coat, Contoured Sanding Disc, (3) Self-Adhesive 2000-Grit Sanding Sheets, Premium Glazing and Spot Putty, Ultra Finishing Compound, and Step-by-Step Instruction Booklet.

NG200 - Premium Repair Kit 0-26916-98011-3

4.5 oz. Kit - Case Pack: 6

CONTENTS

- Scratch Fix 2in1™ Filler Primer
- Scratch Fix 2in1™ Clear Top Coat
- Contoured Sanding Disc
- 3 Self-Adhesive 2000-Grit Sanding Sheets
- Premium Glazing & Spot Putty
- Ultra Finishing Compound
- Step-By-Step Instruction Booklet

PRIMER

NGSF031 - Gray Filler Primer
0-26916-02000-0

CLEAR COAT

NGSF125 - Clear Top Coat
0-26916-02004-8

NGSF100 - Universal Black
0-26916-02002-4

NGSF104 - Universal Flat Black
0-26916-02003-1

NGCC Chrysler Exact-Match Colors

NGFM Ford Exact-Match Colors

NGGM General Motors Exact-Match Colors

HA Honda Exact-Match Colors

HY Hyundai Exact-Match Colors

KA Kia Exact-Match Colors

NS Nissan Exact-Match Colors

MZ Mazda Exact-Match Colors

MT Mitsubishi Exact-Match Colors

SU Subaru Exact-Match Colors

TY Toyota Exact-Match Colors

VW Volkswagen Exact-Match Colors

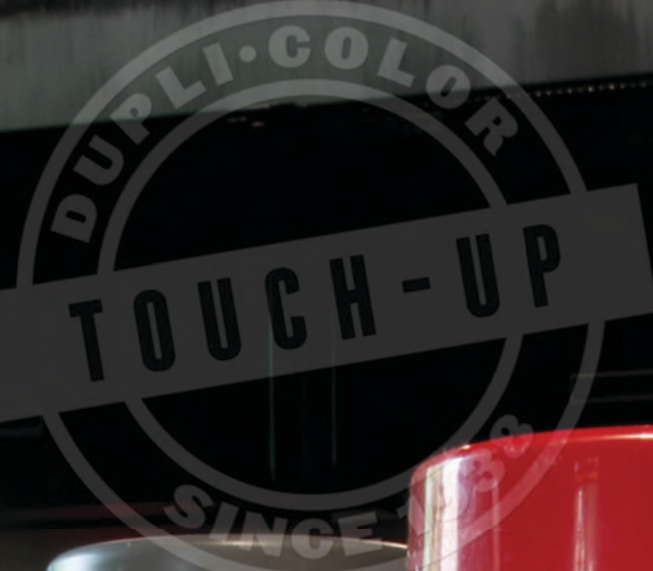

PERFECT MATCH®

Dupli-Color® Perfect Match® Premium Automotive Paint is an easy-to-use, high-quality, fast-drying, acrylic lacquer aerosol paint specially formulated to match the exact color of the original factory applied coating. Ideal for use on all OEM paint surfaces, Perfect Match is available in a complete line of exact-match colors for current and late model import and domestic vehicles, making this product ideal for both small scale vehicle touch-up and for painting vehicle accessories.

8 oz. cans - Case Pack: 6

- Features EZ Touch 360™ Nozzle
- Premium automotive paint
- Available in OEM exact-match colors
- Ensures maximum coverage
- Dry to touch in 30 Minutes / Handle in 1 Hour
- Ideal for large touch-ups and vehicle accessories

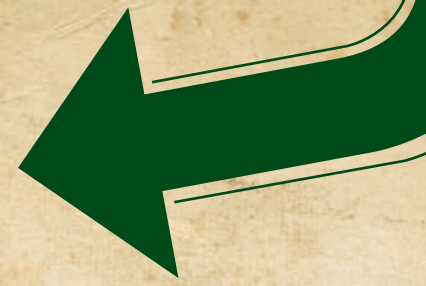

Touch-Up Paint

- BUN0090 - Universal Black Metallic 0-26916-71445-9
- BUN0100 - Universal Gloss Black 0-26916-71442-8
- BUN0104 - Universal Flat Black 0-26916-71444-2
- BCC - Chrysler Exact-Match Colors
- BFM - Ford Exact-Match Colors
- BGM - General Motors Exact-Match Colors
- BHA - Honda Exact-Match Colors
- BHY - Hyundai Exact-Match Colors
- BKA - Kia Exact-Match Colors
- BNS - Nissan Exact-Match Colors
- BMZ - Mazda Exact-Match Colors
- BSU - Subaru Exact-Match Colors
- BTY - Toyota Exact-Match Colors
- BWV - Volkswagen Exact-Match Colors

Primer

BPR0031 - Scratch Filler Primer Gray
0-26916-71454-1

Clear Coat

BCL0125 - Clear Top Coat
0-26916-71440-4

TOTAL COMFORT
MEETS TOTAL
CONTROL





Paint Shop

PAINT SHOP® FINISH SYSTEM

Dupli-Color® Paint Shop® Finish System gives you everything you need to create a high-quality DIY finish-primer, color and clear. Paint Shop® is a high-quality lacquer system designed for automotive and motorcycle applications that is easy to apply, dries quickly and can be buffed to a brilliant smooth finish. Paint Shop® is a ready-to-spray system that requires no mixing or reducing, and with no re-coat window, additional coats can be applied at anytime.

32 oz. cans - Case Pack: 2

- Pre-reduced, ready-to-spray lacquer
- No mixing or reducing required
- Easy to apply and dries quickly
- No recoat window, reapply at any time
- Must be clear coated
- Wet sands easily
- Ideal for automotive exterior body projects

MATTE FINISH CLEAR

Matte your ride out or create custom highlights with Dupli-Color® Paint Shop® Matte Finish Clear Coat. This high grade matte clear features excellent sprayability, leveling and offers superior mar resistance. It's ready to spray and can be applied over any Paint Shop® color for the ultimate in versatility and customization.

PRISM MULTI-COLOR CLEAR AND METALLIC CLEAR

These Paint Shop® Mid-Coat Clears can be applied to any Paint Shop® Color Coat to create unique special effects.

- Prism Multi-Color Clear creates multi-colored effects from all angles depending on the light source
- Metallic Clear adds a brilliant pearl effect, as tiny metallic particles will appear to be suspended in the paint's finish

RELATED



Strainer Kit BSP400 Includes:
3 strainers and 3 stir sticks
0-26916-00065-1
.03 oz - Case pack: 6



Prep & Prepare

Prime

Color

Optional Effects

Clear Coat

Colors

New

New

Molten Red
BSP212
0-26916-64314-6

Champagne Gold
BSP213
0-26916-04307-8

Grey Primer BSP100 0-26916-00076-7	Jet Black BSP200 0-26916-00088-0	Championship White BSP201 0-26916-00081-1	Brilliant Silver (Metallic) BSP202 0-26916-00085-9	Performance Red BSP203 0-26916-00077-4	Deep Blue (Metallic) BSP204 0-26916-00083-5	Burnt Orange Metallic BSP211 0-26916-03397-0
Mineral Grey (Metallic) BSP205 0-26916-00087-3	Chrome Yellow BSP206 0-26916-00080-4	Hugger Orange BSP207 0-26916-00079-8	Sublime Green Pearl BSP208 0-26916-80465-5	Dark Emerald Green Metallic BSP209 0-26916-80466-2	Midnight Blue BSP210 0-26916-80467-9	

Optional

Metallic Clear BSP301 0-26916-03301-7	Prism Multi-Color Clear BSP302 0-26916-03302-4
---	--

Step 3

Gloss Finish Clear BSP300 0-26916-00074-3	Matte Finish Clear BSP307 0-26916-01360-6
---	---

Paint Shop

PAINT SHOP® CANDY COAT

Dupli-Color® Paint Shop® Candy Coat gives the traditional appearance of a candy-coat finish at a fraction of the cost. Paint Shop Candy Coat colors are a unique, translucent formula that allow the bright, metallic surface of the Candy Base Coat to shine through with eye-catching brilliance and depth. The simple four-step process includes Paint Shop primer, Paint Shop Candy Base, Paint Shop Candy Coat and Paint Shop Clear.

32 oz. cans - Case Pack: 2

- Pre-reduced, ready-to-spray lacquer
- Translucent Candy Color adds depth to paint finish
- No mixing or reducing required
- Easy to apply and dries quickly
- No re-coat window, reapply at any time



Colors

Grey Primer
BSP100
0-26916-00076-7

Candy Base Coat Silver
BSP306
0-26916-43942-0

Candy Apple Red
BSP303
0-26916-43939-0

Candy Apple Green
BSP304
0-26916-43940-6

Candy Orange
BSP305
0-26916-43941-3

Clear Coat
BSP300
0-26916-00074-3

Step 1

Step 2

Step 3

Step 4



RELATED



Strainer Kit BSP400 Includes:
3 strainers and 3 stir sticks
0-26916-00065-1
.03 oz - Case pack: 6



Engine Enamel

ENGINE ENAMEL WITH CERAMIC™

Dupli-Color® Engine Enamel contains Ceramic Resins for maximum heat dissipation and gloss retention. The resins offer protection from exposure to excessive heat and automotive fluids. Excellent for under-the-hood applications, Dupli-Color® Engine Enamel will perform to the most rigorous standards of racing, street rod, and vehicle restoration enthusiasts. This durable formula resists temperatures up to 500°F intermittently and produces a superior finish that will not blister, flake, crack or peel.

12 oz. cans - Case Pack: 6

- Features EZ Touch™ Conical Nozzle
- Maximum heat dissipation and high gloss retention
- Ceramic resins resist heat up to 500°F
- Dry to touch in 30 Minutes / Handle in 1 Hour
- Resistant to oil and other automotive fluids
- Will not blister, flake, crack, or peel
- For use on engine blocks and engine accessories

Ford Blue DE1601 0-26916-91601-3	Ford Red DE1605 0-26916-91605-1	Ford Dark Blue DE1606 0-26916-91606-8	Chevrolet Orange-Red DE1607 0-26916-91607-5	General Motors Blue DE1608 0-26916-91608-2	Chevrolet Blue DE1609 0-26916-91609-9
Pontiac Blue DE1610 0-26916-91610-5	New Ford Gray DE1611 0-26916-91611-2	Grey Engine Primer DE1612 0-26916-91612-9	Pontiac Blue Metallic DE1616 0-26916-91616-7	Ford Green DE1617 0-26916-91617-4	Detroit Diesel Alpine Green DE1618 0-26916-91618-1
Chrysler Green DE1619 0-26916-91619-8	Chevrolet Orange DE1620 0-26916-91620-4	Old Ford Blue DE1621 0-26916-91621-1	Chrysler Orange DE1622 0-26916-91622-8	Chrysler Corp. Blue DE1631 0-26916-91631-0	Chrysler Industrial Red DE1632 0-26916-91632-7
Cummins Beige DE1638 0-26916-91638-9	Daytona Yellow DE1642 0-26916-91642-6	Chrysler Hemi Orange DE1652 0-26916-51652-7			

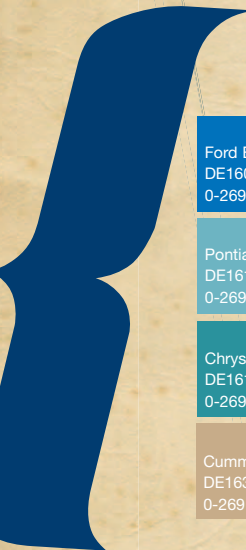

Universal White DE1602 0-26916-91602-0	Universal Gold DE1604 0-26916-91604-4	Gloss Black DE1613 0-26916-91613-6	Aluminum DE1615 0-26916-91615-0	GM/Chrysler Low-Gloss Black DE1634 0-26916-91634-1	Ford Semi-Gloss Black DE1635 0-26916-91635-8
Clear DE1636 0-26916-91636-5	Plum Purple DE1640 0-26916-91640-2	Grabber Green (Lime) DE1641 0-26916-91641-9	Torque 'N' Teal DE1643 0-26916-91643-3	Racing Green (Hunter) DE1644 0-26916-91644-0	Ruby Red DE1645 0-26916-91645-7
Cast Coat Aluminum DE1650 0-26916-91650-1	Cast Coat Iron DE1651 0-26916-91651-8	Red DE1653 0-26916-51653-4			



OEM

Color



Caliper

CALIPER PAINT

Customizing brake calipers has never been easier. Dupli-Color® Caliper Paint is a durable, protective coating resistant to chipping, brake dust, and automotive chemicals. Formulated with ceramic resins, this high-gloss coating resists temperatures up to 500°F. Caliper Paint is available in an aerosol can for applying to brake calipers when removed from your vehicle, and also in a brush-on kit for applying when your brake calipers are not removed from your vehicle. The Dupli-Color Caliper Paint Kit includes: Caliper Paint Pint, Caliper Aerosol Cleaner, Stir Stick, Paint Brush, Masking Tape, and Step-by-Step Instruction Booklet.

Aerosol Paint - 12 oz. - Case Pack: 6, Aerosol Cleaner - 11 oz. - Case Pack: 6, Paint Kit - 16 oz. - Case Pack: 2

- Aerosol Features EZ Touch® Conical Nozzle
- Ceramic resins resist heat up to 500°F
- Fast drying durable finish
- Dry to touch in 30 Minutes / Handle in 1 Hour
- Resistant to chipping, chemicals, and brake dust
- For use on brake calipers, rotors, and drums

CALIPER AEROSOL PAINT

Red BCP100 0-26916-01200-5	Yellow BCP101 0-26916-01201-2	Black BCP102 0-26916-01202-9
Silver BCP103 0-26916-01203-6	Blue BCP104 0-26916-01204-3	Matte Black BCP105 0-26916-04233-0 New

CALIPER AEROSOL CLEANER

Caliper Cleaner BCP200 0-26916-85294-6
--

CALIPER PAINT KIT

Includes: Caliper Paint Pint, Caliper Aerosol Cleaner, Stir Stick, Paint Brush, Masking Tape, and Step-by-Step Instruction Booklet.

Red BCP400 0-26916-40000-0	Racing Black Satin BCP402 0-26916-40002-4	Silver BCP403 0-26916-40003-1
Gloss Black BCP405 0-26916-04313-9 New		



Shadow Black-Out Coating

Dupli-Color® Shadow® Chrome Black-Out Coating is a two-can system that creates the popular look of black chrome on polished metal or chrome surfaces for cars, trucks and motorcycles. The system includes a translucent, black base coat that casts a dark shadow effect. The clear top coat is for added gloss, depth, and protection from the elements. Shadow® is resistant to brake dust, road abrasion, chipping, and fading, making it ideal for chrome wheels, bumpers, interior/exterior trim, accessories, and under hood components.

- Durable high-gloss finish
- Black tinted effect over chrome
- Creates a custom black chrome appearance
- Ideal for wheels, trim, and accessories

SHD1000 - Black-Out Kit

2-Can Kit 11 oz. cans - Case Pack: 2
0-26916-84491-0



SHD1000 0-26916-84491-0

Copper Plate Coating

Dupli-Color® Copper Plate Coating is a two-can system that creates a deep copper effect over high quality polished metal or true chrome surfaces for cars, trucks and motorcycles. The system includes a translucent copper base coat that creates a deep copper effect and a clear top coat that adds gloss, depth, and protection from the elements. Dupli-Color® Copper Plate Coating Kit is resistant to brake dust, road abrasion, chipping, and fading, making it ideal for chrome wheels, bumpers, interior/exterior trim, & accessories.

- Durable high gloss finish
- Deep copper effect over polished metal or chrome surfaces
- Ideal for wheels, trim, and accessories

CK100 Copper Plate Kit

2-Can Kit 11oz. cans -Case Pack: 2
0-26916-03399-4

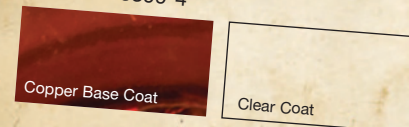

CK100 0-26916-03399-4



Vinyl & Fabric

VINYL AND FABRIC COATING

Restore or customize your interior vinyl seats, dash boards, door panels, shifter boots and consoles with Dupli-Color® Vinyl & Fabric Coating. Formulated with a maximum adhesion promoter so there's no need for primer. Dupli-Color Vinyl & Fabric Coating won't crack, peel or chip.

11 oz. cans — Case pack: 6

- Features EZ Touch® Conical Nozzle
- Flexible self-priming formula
- Resists cracking, flaking, and peeling
- Dry to touch in 30 Minutes / Handle in 1 Hour



OEM COLORS

Gloss Black HVP104 0-26916-39980-9	White HVP105 0-26916-39981-6	Flat Black HVP106 0-26916-39982-3
Desert Sand HVP108 0-26916-39984-7	Medium Gray HVP109 0-26916-39985-4	Burgundy HVP110 0-26916-39986-1
Charcoal Gray HVP111 0-26916-39987-8	Medium Blue HVP112 0-26916-39988-5	Medium Beige HVP113 0-26916-39989-2

TUNER COLORS

Red HVP100 0-26916-40008-6	Blue HVP102 0-26916-40010-9	Silver HVP103 0-26916-40011-6
----------------------------------	-----------------------------------	-------------------------------------

TRUNK SPATTER PAINT

Dupli-Color® Trunk Spatter Paint duplicates the speckled finish of OEM trunk interiors. Its high-build formula covers scars and abrasions and restores trunk interior to a "like-new" factory finish. Ideal for use on trunk interiors, storage chests and metal lockers.

- Multi-color textured trunk paint
- Duplicates original OEM trunk spatter finish
- Dry to touch in 1 hour / Handle in 2 hours
- Also for use on storage chests and metal lockers

11 oz. cans — Case pack: 6



TRIM PAINT

Dupli-Color® Trim Paint is formulated to restore an OEM Flat Black finish to metal trim and molding around windows, body sides, and other vehicle areas. Trim Paint is a quick-drying and durable coating ideal for trucks, cars, motorcycles and RVs.

11 oz. cans - Case Pack: 6

- Features EZ Touch® Conical Nozzle
- Satin black finish restores faded trim
- Dry to touch in 30 Minutes / Handle in 1 Hour
- Use on interior and exterior trim and molding

Trim Paint
TP70
0-26916-90070-8

FLEXIBLE BUMPER COATING

Dupli-Color® Flexible Bumper Coating renews and protects weathered or discolored bumpers, molding, and rub strips. This tough, protective coating offers a uniform, solid color with superior adhesion to thermoplastic rubber and polyurethane bumpers that won't flake, chip, or peel.

11 oz. cans — Case pack: 6

- Features EZ Touch® Fan Spray Nozzle
- Renews and protects discolored bumpers
- Superior adhesion
- Dry to touch in 30 Minutes / Handle in 1 Hour
- Provides a uniform solid color
- For use on thermoplastic and polyurethane bumpers

Black
FB105
0-26916-34105-1

Gray
FB106
0-26916-34106-8

Medium Silver
FB108
0-26916-34108-2

Dark Charcoal
FB109
0-26916-34109-9



AUTOMOTIVE METALLIC

Dupli-Color® Automotive Metallic products provide a brilliant metallic finish to automotive trim and accessories. Available in Chrome and Gold, Dupli-Color® Automotive Metallic products are ideal for interior and exterior use.

11 oz. cans - Case Pack: 6

- Features EZ Touch® Fan Spray Nozzle
- Brilliant metallic finish
- Dry to touch in 30 Minutes / Handle in 1 Hour
- Ideal for use on accessories, trim, and molding

Chrome
CS101
0-26916-33101-4

Gold
GS100
0-26916-34100-6

STAINLESS STEEL

Dupli-Color® Stainless Steel Coating provides the brilliant and popular look of stainless steel to automotive accessories, such as trim, grills, and bumpers. Stainless Steel Coating dries quickly to a durable finish and resists temperatures up to 250°F, allowing for underhood applications. Features excellent adhesion to metal, wood, iron, glass, and most other surfaces.

- Creates the high quality look of stainless steel
- Ideal for automotive trim and accessories
- Durable finish

11 oz cans - Case Pack 6

Stainless Steel
SS100
0-26916-01410-8





METAL SPECKS™

Dupli-Color® Metal Specks™ combines 'old school' color with 'new school' technology to create the next evolution in metal flake paints of the past. Create a unique and custom brilliant-metallic finish with this coating that features tiny floating metallic flake suspended in vibrant paint. Metal Specks is ideal for customizing automotive accessories such as spoilers, mirrors, and molding.

11 oz. cans - Case Pack: 6

Burnt Copper
MS100
0-26916-02610-1

Sparkle Silver
MS200
0-26916-02606-4

Retro Red
MS300
0-26916-02607-1

Ocean Blue
MS400
0-26916-02608-8

Shimmering Green
MS500
0-26916-02609-5

- Heavy metallic paint
- Brilliant metal flake shimmer
- Easy to use and dries quickly
- Dry to touch in 30 Minutes / Handle in 1 Hour
- Use on auto accessories and recreational equipment

METALCAST™

Dupli-Color® Metalcast™ Anodized Color turns ordinary chrome pieces into a bright, transparent-colored metallic finish in an easy one-step process. Metalcast is a durable enamel finish that is oil, gas, and heat resistant to 500° F intermittently, making it ideal for interior, exterior, and high-heat applications under the hood. Specially formulated to work over properly prepared shiny, bare metal, and faux chrome-like surfaces.

Paint tip: Clear coat with DE1636 Engine Enamel Clear for added gloss and durability.

11 oz. cans - Case Pack: 6

Red Anodized
MC200
0-26916-00638-7

Blue Anodized
MC201
0-26916-00639-4

Yellow Anodized
MC202
0-26916-00640-0

Green Anodized
MC203
0-26916-98009-0

Purple Anodized
MC204
0-26916-98010-6

Orange Anodized
MC205
0-26916-98012-0

Ground Coat
MC100
0-26916-00637-0

Smoke
MC206
0-26916-98013-7

- Features EZ Touch® Fan Spray Nozzle
- Creates an anodized color effect
- Dress up chrome or polished metal surfaces
- Resistant to heat up to 500° F
- Dry to touch in 30 Minutes / Handle in 1 Hour
- Use on chrome automotive accessories



TEXTURED METALLIC™

Dupli-Color® Textured Metallic Coating combines textured particles with metallic highlights to create a unique finish and color. This skid-resistant coating can be used on interior finishes including trunks, dashboards, door trim, and more. Textured Metallic Coating is easy to apply, fast-drying, and does not require a primer.

- Textured coating with metallic highlights
- Skid resistant surface
- Easy to apply and covers surface blemishes
- Dry to touch in 30 Minutes / Handle in 1 Hour
- Use on dashboards, trunks, and molding

11 oz. cans - Case Pack: 6

Graphite
MX100
0-26916-40012-3

Charcoal
MX101
0-26916-40013-0

Silver
MX102
0-26916-40014-7





EFFEX™

Give non-metallic paint a brilliant glitter effect with Dupli-Color® Effex™. Available as a clear top coat which allows the base color it is applied over to shine through.

Effex is formulated with tiny, brilliant-metallic particles that change colors when exposed to various angles of light. Ideal for accessories like body molding, hood scoops, mirrors and spoilers.

- Features EZ Touch® Fan Spray Nozzle
- Brilliant glitter effect
- Tiny metallic prism flakes change color in light
- Easy to use and dries quickly
- Dry to touch in 20 Minutes / Handle in 1 Hour
- Ideal for body, molding, scoops, and mirrors

Clear over red

Clear over blue

Clear over green

EFX100 Clear 0-26916-01190-9
7 oz. can — Case pack: 6

MIRAGE®

Dupli-Color® Mirage® Color System is a unique, color-shifting aerosol paint formulated to create multi-colored effects from all angles. As the light source and viewing angle changes, the color appears to change. Mirage is a quick-drying, UV-resistant formula that adheres well to steel, aluminum, and plastic and is easy to apply using a three-step process that consists of base coat, mid-coat color and top coat.

- Features EZ Touch® Fan Spray Nozzle
- Easy three-step process
- Creates a unique, color-shifting effect
- Dry to touch in 30 Minutes / Handle in 1 Hour
- Use on automotive and motorcycle accessories

Kit includes: 3- 8 oz. cans - Case Pack: 2 Kits

Red/Blue Kit
MP403
0-26916-98006-9

HOT TIRES™

Whether your tires are old or new, Dupli-Color® Hot Tires™ gives you a way to add color or personalize your muscle car, truck, or sport compact tires. This fast-drying, durable coating allows you to touch-up faded white walls or tattoo your high performance tires. Hot Tires goes on smooth, resists fading, and is available in an easy-to-use pen.

- Create custom effects on tires
- Restore faded white walls
- Easy to use and dries quickly
- Dry to touch in 15 Minutes / Handle in 30 minutes
- Use on all types of tires

0.5 oz. tubes - Case Pack: 6

White
HT100
0-26916-01250-0

Red
HT200
0-26916-01251-7

Yellow
HT300
0-26916-01253-1



Kevlar.
Made Kevlar Strong

BED ARMOR

BED ARMOR™

Kit: Gallon - 128 oz. - Case Pack: 2, Quart* - 32 oz. - Case Pack: 2

Dupli-Color® Bed Armor™ Do-It-Yourself Truck Bed Liner is a water-based, rubberized polyurethane coating. It is ideal for protecting truck beds and all other metal, aluminum, fiberglass, and wood surfaces. Bed Armor is the only do-it-yourself truck bed liner formulated with DuPont™ Kevlar®. This special formula won't chip, fade, or flake and has a textured, black satin finish that provides the ultimate in truck bed protection. The Bed Armor Truck Bed Protection Kit includes: (1) Bed Armor gallon, roller cover and frame, roller tray, trim brush, scuff pad, stir stick, and a step-by-step instruction booklet.

- DIY Truck Bed Liner with DuPont™ Kevlar®
- Water-based polyurethane coating
- Durable and rubberized finish extends bed life
- Impact resistant finish won't flake, chip, or peel
- Use on metal, wood, fiberglass, and concrete

Black Kit
BAK2010
0-26916-84494-1

Black Quart*
BAQ2010
0-26916-84493-4

*Quart sold separately from Bed Armor Kit

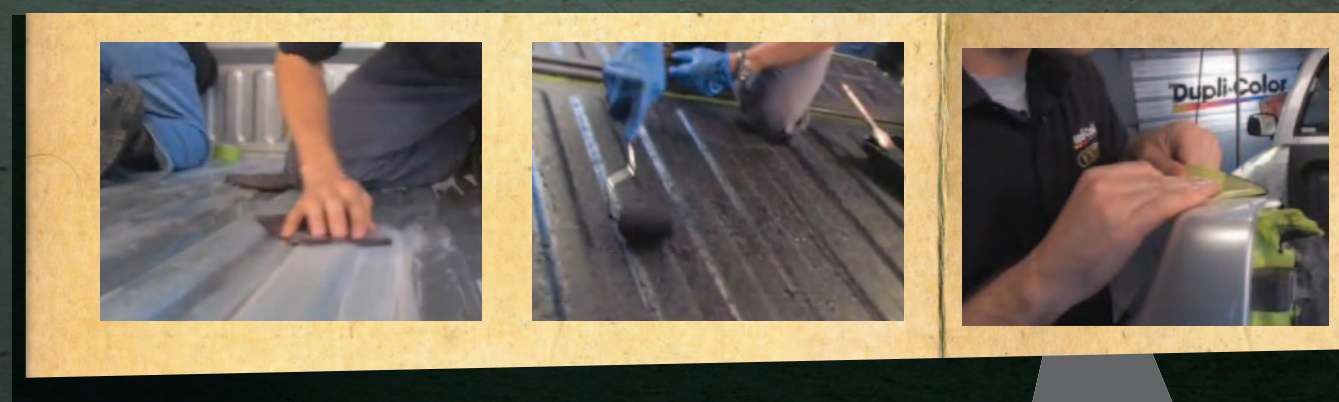

BED ARMOR™ AEROSOL

16.5 oz Aerosol - Case Pack: 6

Dupli-Color® Bed Armor™ Do-It-Yourself Truck Bed Liner is now available in aerosol. Just like the Bed Armor™ Truck Bed Kit, it's easy to use and offers the same durability and protection. Bed Armor™ aerosol is a water-based polyurethane formulated with ground up rubber particles to provide uniform texture and skid resistance. Bed Armor™ aerosol is perfect for cutting in or for touch-up and can be used on wood, concrete, fiberglass and metal.

Black
BAA2010
0-26916-01355-2



NEW!



TRUCK BED COATING SPRAY GUN

Our new truck bed coating gun is ideal to create a uniform coating for larger truck beds or any larger wood, concrete, fiberglass or metal surface areas.

VG100
26916-04327-6

THE ULTIMATE IN TRUCK BED PROTECTION





TRUCK BED COATING *Aerosol - 16.5 oz. Cans - Case Pack: 6, Gallon - 128 oz. - Case Pack: 2*

Dupli-Color® Truck Bed Coating is a durable, black vinyl polymer coating that protects truck beds at a fraction of the cost of conventional drop-in truck bed liners. Dupli-Color® Truck Bed Coating is designed for the do-it-yourself user and is available with multiple application methods. It can be applied using a roller, spray gun, or aerosol spray can making it ideal for use as an all-purpose protective coating for truck beds, inner fenders, tailgates, bedrails, cargo vans, step areas, and running boards.

- Versatile all-purpose protective coating
- Durable impact resistant coating
- Dry to touch in 1 Hour / Handle in 2 Hours
- Use on truck beds, Jeep tubs, and frames

AEROSOL

TR250 - Black 0-26916-60250-3

Black
TR250

BULK

TRG250 - Gallon 0-26916-61250-2
TRG300K - Gallon Kit 0-26916-01163-3

Black

ACCESORIES

TRG102 - Professional Spray Gun 0-26916-61102-4
TRG103 - Roller Kit 0-26916-00103-0
TRC104 - Replacement Roller Cover 0-26916-00104-7
BAG100 - Truck Bed Coating Spray Gun

UNDERCOATING

UC101 - 16 oz. cans - Case Pack: 12, UC102 - 17 oz. cans - Case Pack: 12

Dupli-Color® offers a complete line of undercoating products ideal for providing protection for wheel wells, gas tanks, frames and supports, weld joints, floor pans, doors, and quarter panels. Dupli-Color® Undercoat (UC101) offers economical protection plus paintability, moisture resistance, corrosion resistance, and a durable rubberized finish. Dupli-Color® Professional Undercoat with Sound Eliminator (UC102) provides superior protection by also reducing road vibrations and road noise.

- Protective and paintable rubberized finish
- Resists rust and improves appearance
- Reduces road noise
- Dry to touch in 1 Hour / Handle in 2 Hours
- Use on vehicle underbodies and trailers

Paintable Rubberized Undercoat
UC101 - Black 0-26916-60101-8

Black
UC101

Professional Undercoat and Sound Eliminator
UC102 - Black 0-26916-60102-5

Black
UC102



Dupli-Color®
PROFESSIONAL Undercoat
with Sound Eliminator

- Paintable
- Rubberized
- Corrosion Proof
- Quick Dry

Net Wt. 17 oz (1 lb 1 oz) 481 g



General Purpose

PREMIUM ENAMEL

Dupli-Color® Acrylic Enamels deliver the ultimate protection, gloss and color retention. A superior, high-solids formula ensures maximum coverage and performance.

12 oz. cans — Case pack: 6

Gloss Black (OSHA Black) DA 1600 0-26916-92600-5	Semi-Gloss Black DA 1603 0-26916-92603-6	Flat Black DA 1605 0-26916-92605-0	Medium Grey DA 1610 0-26916-92610-4	Machinery Grey DA 1612 0-26916-92612-8	Royal Blue DA 1620 0-26916-92620-3
Leaf Green DA 1630 0-26916-92630-2	Cherry Red (Equipment Red) DA 1640 0-26916-92640-1	Leather Brown DA 1656 0-26916-92656-2	Light Yellow DA 1660 0-26916-92660-9	School Bus Yellow DA 1663 0-26916-92663-0	Gloss White DA 1670 0-26916-92670-8
Flat White DA 1672 0-26916-92672-2	Chrome Aluminum DA 1684 0-26916-92684-5	Chrome Yellow (Hot Rod Color) DA 1687 0-26916-92687-6	Crystal Clear DA 1692 0-26916-92692-0	Purple Passion DA 1688 0-26916-92688-3	

PREMIUM LACQUER

Dupli-Color® Lacquer is a fast-drying, premium-quality formula that provides quick coverage, weatherability and adhesion. Perfect for automotive trim and detail projects, it delivers a rich glossy finish every time.

12 oz. cans — Case pack: 6

Flat Black DAL 1607 0-26916-93607-3	Semi-Gloss Black DAL 1608 0-26916-93608-0	Gloss White DAL 1675 0-26916-93675-2
Gloss Black DAL 1677 0-26916-93677-6	Silver Metallic DAL 1679 0-26916-93679-0	Clear Lacquer DAL 1695 0-26916-93695-0

Professional Aerosol

PRIMER S

A wide range of specialized automotive professional primers meets today's body shop needs. Tested to ensure reliable results for the special application they are designed to cover. Make surfacing and priming faster and easier.

PRIMER SEALER

Dupli-Color® Professional Primer Sealer is ideal for maximum corrosion resistance and bonding of base colors. Use before top coat is applied, especially when overcoating with a lighter color. Seals for excellent color hold-out and provides a smooth uniform surface for top coating.

12 oz. cans — Case pack: 6

0-26916-68103-4 DPP103 Primer Sealer (Non-sanding)

FILLER PRIMER

Provides a smooth rust-resistant basecoat that improves adhesion and appearance of top coat. The fast-drying, sandable formula features outstanding high-build and feather edging. Ideal for use on metal, wood and fiberglass.

12 oz. cans — Case pack: 6

0-26916-68104-1 DPP104 Grey Filler Primer
0-26916-68105-8 DPP105 Red Filler Primer
0-26916-68106-5 DPP106 Black Filler Primer

FLEXIBLE PRIMER

Improves adhesion on both interior and exterior surfaces. Excellent for flexible surfaces and provides a smooth base for top coat. Ideal for use on rigid and semi-rigid plastics including bumper covers.

12 oz. cans — Case pack: 6

0-26916-68107-2 DPP107 Flexible Primer

WELD-THROUGH/COLD GALVANIZED PRIMER

Dupli-Color® Professional Weld-Through/Cold Galvanized Primer provides maximum corrosion resistance with a durable, zinc-rich coating that can be applied directly to dry metal or galvanized surfaces. Features outstanding feather edging.

12 oz. cans — Case pack: 6

0-26916-68108-9 DPP108 Weld-Through/Cold Galvanized Primer

SELF-ETCHING PRIMER

Dupli-Color® Professional Self-Etching Primer etches and primes in one easy step. It features superior adhesion and is perfect for spot repairs. Can be used under all of today's automotive finishes. Ideal for most plastic, fiberglass, bare steel, aluminum and stainless steel.

12 oz. cans — Case pack: 6

0-26916-68101-0 DPP101 Self-Etching Primer (Green)

HI-BUILD FLEET COATING

16 oz. cans - Case Pack: 6, *15.5 oz. cans - Case Pack: 6 (Flat Black, Stainless Steel, Aluminum)

Dupli-Color Hi-Build Fleet Coating is a high-solids enamel paint that provides superior coverage and durability. It's ideal for over-the-road applications due to its chemical resistance and corrosion protection formulation. Hi-Build Fleet Coating is available in a large 16 oz. can (most colors) for maximum coverage and is offered in a variety of popular fleet application colors.

- Features EZ Touch® Conical Nozzle
- Provides a durable and rust resistant finish
- Superior high-solids enamel formula
- Dry to touch in 30 Minutes / Handle in 1 Hour
- Use on metal, wood, and fiberglass

Gray Primer HB100 0-26916-12100-4	Gloss Black HB101 0-26916-12101-1	Semi-Gloss Black HB102 0-26916-12102-8
Fleet White HB104 0-26916-12104-2	Fleet Red HB105 0-26916-12105-9	
Cast Coat HB108 0-26916-12108-0	Stainless Steel* HB109 0-26916-12109-7	





Specialty Chemicals

ACETONE

A premium cleaner for most any surface, acetone cleans unpainted fiberglass surfaces and removes surface dust, dirt and grease from glass, metal, leather and wood. Evaporates quickly and leaves no residue behind.

32 oz. quart — Case pack: 6, 128 oz. gallon — Case pack: 4

0-26916-60521-4	CM521	Quart
0-26916-60522-1	CM522	Gallon

LACQUER THINNER

A premium thinner for all lacquers. This superior product can be used for both spray or dip application. Cleans the surface prior to applying lacquer and degreases tools and lacquer spray equipment.

32 oz. quart — Case pack: 6, 128 oz. gallon — Case pack: 4

0-26916-60501-6	CM501	Quart
0-26916-60502-3	CM502	Gallon

PRIMER SURFACER

Provides excellent adhesion to help improve corrosion resistance and enhance paint color.

0-26916-61900-6	BQ900	Quart
0-26916-62900-5	BG900	Gallon

PAINT THINNER

Our paint thinner is made from 100% mineral spirits. It thins all oil-based paints, varnishes, stains, enamels and polyurethanes. Cleans dirt and grease from surfaces prior to painting, staining or finishing and allows paint to bond better to the surface.

32 oz. quart — Case pack: 6, 128 oz. gallon — Case pack: 4

0-26916-60531-3	CM531	Quart
-----------------	-------	-------

SPECIALTY REDUCER

Designed to thin Dupli-Color® Primer Surfacer and to help meet VOC requirements. Use in all weather conditions.

0-26916-62906-7	BG906	Quart
0-26916-62907-4	BG907	Gallon

SPECIALTY

Dupli-Color® Professional Specialty Products offer a variety of aerosols perfect for many automotive applications. Quality, performance and ensured results make them products you can count on to "get the job done right."

GUIDE COAT

Dupli-Color® Professional Guide Coat provides a perfectly smooth finish for contouring repair areas. The fast-drying, easy-to-sand formula exposes surface low spots and imperfections. Provides a smooth, dark gray finish.

12 oz. cans — Case pack: 6
0-26916-64102-1 DPS 102 Guide Coat

EDGING CLEAR

Dupli-Color® Professional Edging Clear provides an ideal clear coat for door jambs and cutting in of replacement parts. Ideal for spot repairs.

16 oz. cans — Case pack: 6
0-26916-64103-8 DPS 103 Edging clear



OMNI-PAK® FILL ONE AEROSOL FILLING STATIONS



Fill-One is a revolutionary aerosol filling system that delivers perfectly-blended aerosols without cleaning. Let's face it, nobody likes cleaning, especially messy aerosol filling machines. The Fill-One Aerosol Filling System fills cans through the aerosol can cap, which reduces waste, eliminates clean-up, and leaves a permanent color indicator on the outside of the cap.

- Seconds to fill with no loss of paint product
- Compact system about the size of a coffee maker
- Save money by eliminating costly labor and cleaning solvent

B10001000 Fill-One Machine

OMNI-PAK® FILL-ONE CANS

Omni-Pak® Fill-One Cans come with the specialized filling cap that allow for clean-free aerosol can filling.

- Seconds to fill with no loss of paint product
- Compact system about the size of a coffee maker
- Save money by eliminating costly labor and cleaning solvent

B55216000	Master-Blend™ Fill-One
B55316000	One-Blend Fill-One
B55416000	Enamel Blend Fill-One
B55516000	Lacquer Blend Fill-One

16 oz. cans — Case Pack: 12



OMNI-FILL® AEROSOL FILLING STATIONS

A custom aerosol filling system that allows you to custom match the specific color you need. Use with solvent base, air-dry enamels, lacquers, vinyl and acrylics. It is a low maintenance operation that is fast and easy to clean. Just select the right size system for your needs from a hand-operated model for filling one can at a time to our automated models for quickly filling multiple quantities.

For more information about Omni-Fill® Aerosol Filling Systems, contact your local Dupli-Color® representative.

B10000	Omni-Fill® Super 100 Automatic/Pneumatic Case wt. 95 lbs.
B11011	Omni-Fill® 11EZ Hand Operated Case wt. 14 lbs.
B00035	Omni-Fill® 35 Automatic/Pneumatic Case wt. 55 lbs.
B15015	Omni-Fill® 15 Hand Operated Case wt. 47 lbs.



Acrylic Enamels Lacquers

Gloss White DPE101 0-26916-63101-5	Flat White DPE102 0-26916-63102-2	Gloss Black DPL101 0-26916-62101-6	Dull Aluminum DPL104 0-26916-62104-7
Gloss Black DPE103 0-26916-63103-9	Semi-Gloss Black DPE104 0-26916-63104-6	Semi-Gloss Black DPL102 0-26916-62102-3	Chrome Aluminum DPL105 0-26916-62105-4
Flat Black DPE105 0-26916-63105-3	Clear DPE106 0-26916-63106-0	Flat Black DPL103 0-26916-62103-8	Gloss White DPL108 0-26916-62108-5
Chrome Aluminum DPE111 0-26916-63111-4	Dull Aluminum DPE112 0-26916-63112-1	Clear DPL106 0-26916-62106-1	